

# Granny Flats

BY HALLMARK



## DESIGN BROCHURE

[www.grannyflatsbyhallmark.com.au](http://www.grannyflatsbyhallmark.com.au)



## THE GUM

- Studio with Kitchenette
- Total Area
- 34 sq metres

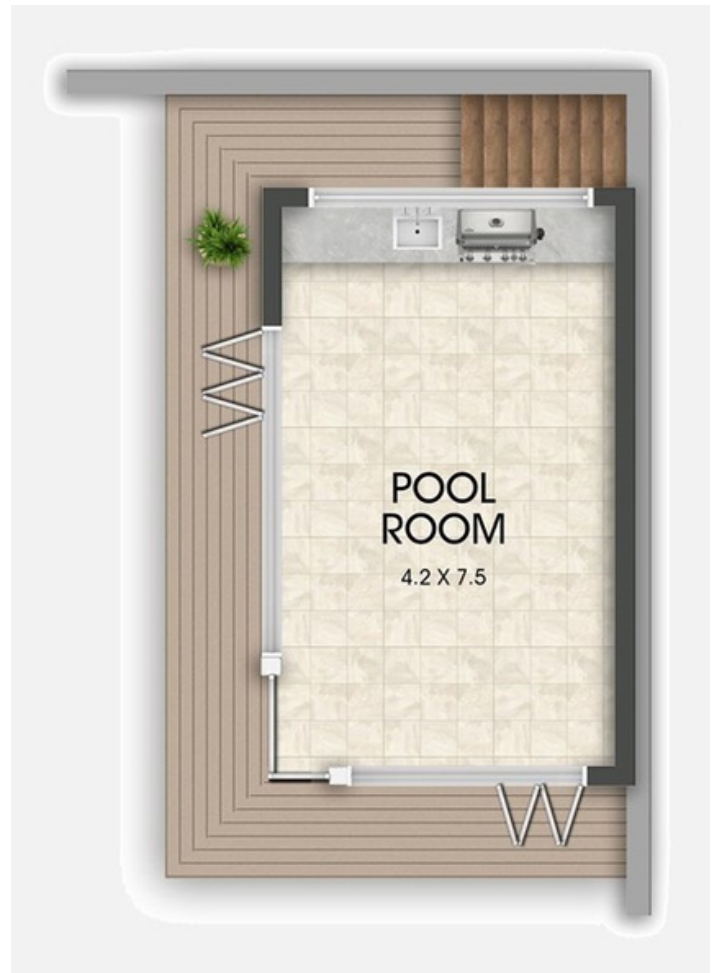

## STUDIO RANGE



## THE WATTLE

- Studio
- Kitchen
- Bathroom
- 40 sq metres







## THE TUART

- One Bedroom
- Semi-Ensuite
- Kitchen
- Living /Meals Area
- 40 sq metres  
EXCLUDING VERANDAH



## ONE-BED RANGE



## THE EUCALYPT

- One Bedroom
- One Bathroom
- Kitchen
- Meals/Living Space
- Verandah
- 50 sq metres  
EXCLUDING VERANDAH







# THE MARRI

56 sq metres

EXCLUDING VERANDAH

- One Bedroom
- Kitchen & Living Space
- One Bathroom
- Verandah Options

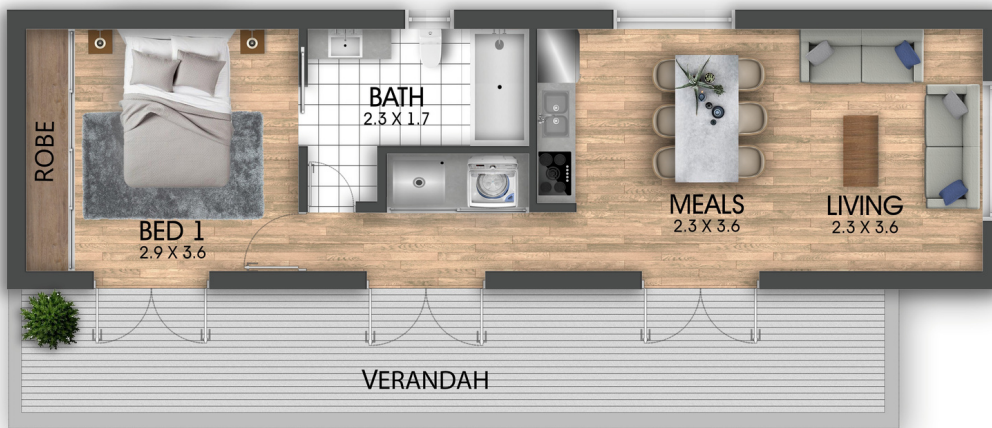

## ONE-BED RANGE



# THE PAPERBARK

- One Bed with Two Bed Option
- Open Plan Kitchen
- Meals & Living Space
- One Bathroom
- Verandah Options
- 60 sq metres EXCLUDING VERANDAH







70 sq metres

EXCLUDING VERANDAH

## THE JARRAH

- Two Bedrooms
- One Bathroom
- Open Plan Living
- Kitchen
- Meals
- Living
- Verandah Options



## TWO-BED RANGE



## THE BLACKBUTT

- Two Bedroom
- One Bathroom
- Open Plan Kitchen
- Living Space
- Alfresco Options
- 69 sq metres

EXCLUDING VERANDAH







# THE WILLOW

- Two Bedroom
- Two Bathrooms
- Open Plan Kitchen
- Living Space
- 63 sq metres



## TWO-BED RANGE



# THE BANKSIA

- Two Bedroom
- One Bathroom
- Open Plan Living
- Kitchen
- Living
- Meals
- 70 sq metres







# TWO-STOREY RANGE

## THE IRONBARK

- One Bedroom
- Open Plan Kitchen
- Carport & Storeroom
- Semi-Ensuite Bathroom
- Living/Meals Space
- 55 sq metres



# HERE TO HELP

## Do You Supply the Granny Flat in Kit Form?

No, all of our granny flats are built to your plan on site, brick by brick.

## What areas do you build in?

We are mainly focussed on the Perth northern suburbs, but please check with us.

## Can I Rent Out a Granny Flat to Non-Family Members?

Yes, new legislation in WA means you can now rent the property to anyone and not just family members.

## Do I Have to Use One of the Designs on Your Website?

Absolutely not, we can modify one of our floor plans to suit your requirements, or custom design something based on your specific needs.

## What is the Maximum Allowable Size I Can Build My Granny Flat?

Up to 70 sqm

## Do I Need a Council Approvals?

Yes. To build any dwelling it is necessary to have a Building Permit, but don't worry, we handle all of this for you.

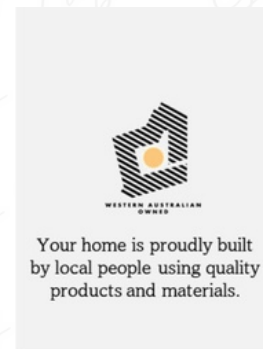

Your home is proudly built by local people using quality products and materials.



In as little as 16 weeks from slab down, you can move in!



Personal service from design to completion.



We custom design all your plans..



You can enjoy direct contact with your site supervisor



Fixed price contract.

Please reach out if you have any questions or would like more information.

e: [info@grannyflatsbyhallmark.com.au](mailto:info@grannyflatsbyhallmark.com.au)

p: (08) 9408 6399